

Project:



**Scan for more info!**

Owners manual  
Quick install  
Quick sizing  
Install layout  
Parts list

**CM-T-4V-PBV**

**CM-T-6V-PBV**

**CM-T-8V-PBV**

**Post Mix Tower**



**4, 6 & 8 Valve Post Mix Soda Tower**

- Blue LED Illuminated Push and hold to dispense buttons
- Integrated Base & Drip pan
- Valves can be configured for carbonated or non-carbonated beverages
- 304 stainless steel brushed finish
- Key to lock out dispense buttons

**Specifications**

- Faucet flow rate: 1.5-2.0 oz/sec
- Clearance: 10"
- 20"W x 12"D x 17.375"H
- 120V - 1 Amp - 60 Hz
- Dispense tower to be paired with the CBDS cold carb or non-carb remote chiller.

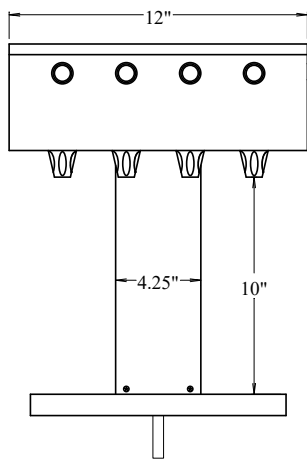

**CM-T-4V-PBV**

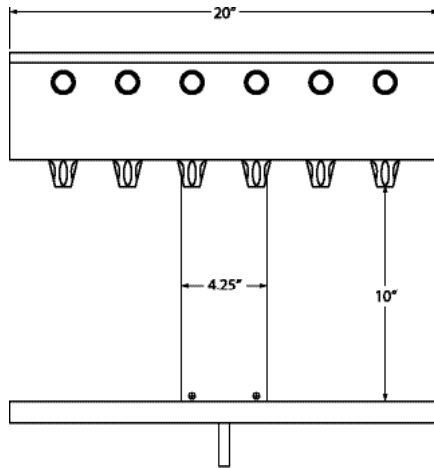

**CM-T-6V-PBV**

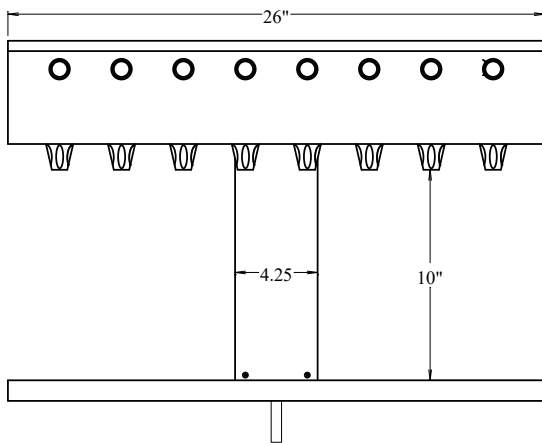

**CM-T-8V-PBV**

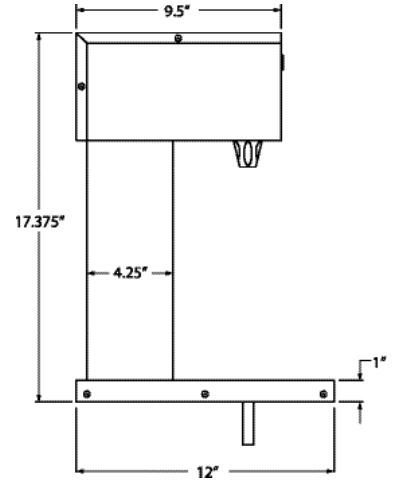

## Required components

- **CR-24FCP**  
Water Filter System



- **BIB Racks**  
4, 6 or 8 Product Bag-in-Box rack with pumps and secondary regulator



- **CBDS Series**  
Refrigerated chiller systems with syrup coils



- **CBDS Series Insulated Trunkline**  
CBDS-06002  
CBDS-08002  
CBDS-10004

